



## S Handle Installation Instructions

Typically this handle will be purchased initially with the Model 1900 pump. If it is purchased later, then follow these instructions to remove the existing handle and install the S handle.

1. Open the box and inspect the contents. Verify that you have received everything that you ordered. If there is anything that is missing or doesn't match, please call us immediately to correct the situation (1-800-339-2601).
2. To remove the existing handle, remove the handle shoulder bolt and top link bolt. Set the bolts, nuts and washers aside. **See Diagram A.**
3. To install the S handle, insert the handle shoulder bolt through the handle and lift rod connector.
4. Attach the handle shoulder bolt nut and tighten. **Make sure to not over torque this nut as it creates a friction point making pumping more strenuous.**
5. Insert the top link bolt through the links and handle tab, placing a washer on each side of each link.
6. Attach the link bolt nut onto the link bolt and tighten. **Make sure to not over torque this nut as it creates a friction point making pumping more strenuous.**
7. Grasp the handle and pull up and down. Listen for the "Burp" sound of the Check Valves. As the handle is pulled upward the bottom Check Valve should make a "Burping" sound. When the handle is pushed downward, the Piston Check Valve should make a "Burping" sound.
8. If the Packing Gland Nut is leaking, tighten  $\frac{1}{4}$  turn until it stops.

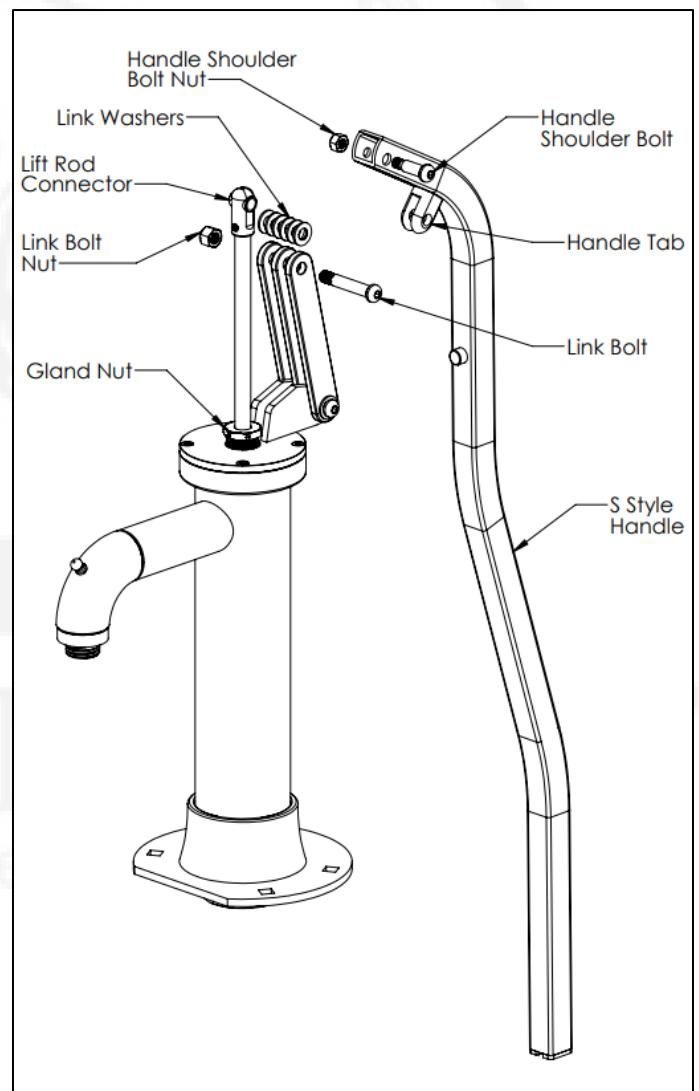

Diagram A

Follow all other instructions and guidelines for the Model 1900 Pump.